



State of Illinois

ENVIRONMENTAL PROTECTION AGENCY

Mary A. Gade, Director
217/ 782-6760

2200 Churchill Road, Springfield, IL 62794-9276

Certified # 363 547 781

July 31, 1997

J. David Moniot
U.S. Steel
600 Grant Street
Pittsburgh, PA 15219-2749

Re: 0316515061/ Cook County
Chicago/U.S. Steel South Works
Site Remediation/Technical

Dear Mr. Moniot:

The Remedial Action Completion Report (entitled "Remediation Activities Report", dated September 4, 1996; and "PCB Supplement to the Remediation Activities Report" dated October 28, 1996,) for the South Works site has been reviewed by the Illinois Environmental Protection Agency (Illinois EPA) and demonstrates that the remedial actions were completed in accordance with the Remedial Action Plans (entitled "Site Sampling Plan, Site Safety Plan and Analytical Quality Assurance Plan for the Former South Works Plant," dated June 16, 1994; "Process Water Sewer, Pits and Equipment Cleaning at U.S. Steel South Chicago Works" and addendum, 1994; "Confirmatory Sampling Plan for the South Works Site Chicago, Illinois," dated October 11, 1994; "Post Remediation Sampling Plan for the South Works Site Chicago, Illinois," dated November 20, 1995).

The property consists of approximately 567 acres and includes a parcel of land in Section Thirty-two (32), Township Thirty-eight (38), North, Range Fifteen (15) East, and in Section Five (5), Township Thirty-seven (37) North, Range Fifteen (15) East of the Third Principal Meridian in the City of Chicago, Cook County, Illinois, and a parcel of land in the Southwest Quarter (SW 1/4) of Section Thirty-two (32), Township Thirty-eight (38) North Range Fifteen (15) East of the Third Principal Meridian, in the City of Chicago, Cook County, Illinois (more particular descriptions are included in the attached Notice); and is commonly known as 3426 East 89th Street; Chicago, Illinois. Pursuant to Section 58.10 of the Illinois Environmental Protection Act ("Act") (415 ILCS 5/58.10), your request for a no further remediation determination is granted under the conditions and terms specified in this letter.

Issuance of this comprehensive No Further Remediation Letter (Letter) signifies a release from further responsibilities under the Act in performing the approved remedial action and shall be considered prima facie evidence that the remediation site described in the Environmental Notice and

does not require further remediation under the Act if utilized in accordance with the terms of this Letter. This No Further Remediation Letter does not extend to areas outside of the remediation site described in the Environmental Notice. Specifically, this letter does not cover the near shore areas of Lake Michigan, the Calumet River, the North Vessel Slip (Parcel B of the legal description in the Environmental Notice), the South Vessel Slip (Parcel C), U. S. Government Properties (Parcels D and E) and the Elgin, Joliet and Eastern Railroad Company Property (Parcel A).

Conditions and Terms of Approval

Level of Remediation and Land Use Limitations

The levels of the remediation objectives for this site have been established in accordance with a residential land use criteria and are specified in the "Human Health Risk Assessment for the South Works Site, Chicago, Illinois" dated August 25, 1995.

Preventive, Engineering, and Institutional Controls

Institutional controls There shall be no construction, installation, maintenance or utilization of a groundwater well for potable water use within the site area.

Other Terms

1. All materials containing PCBs, asbestos or other regulated substances encountered during the demolition of the No. 5 Powerhouse and other remaining building structures must be properly handled, disposed and remediated according to all applicable State and Federal Regulations.
2. Further information regarding this remediation site can be obtained through a written request under the Freedom of Information Act (5 ILCS 140) to:

Illinois Environmental Protection Agency
Attn: Freedom of Information Act Officer
Bureau of Land #24
2200 Churchill Road
P.O. Box 19276
Springfield, IL 62794-9276

3. Pursuant to Section 58.10(f) of the Act (415 ILCS 5/58.10(f)), should the Illinois EPA seek to void this Letter, the Illinois EPA shall provide notice to the current title holder and to the Remediation Applicant at the last known address. The notice shall specify the cause for the avoidance, explain the provisions for appeal, and describe the facts in support of this cause. Specific acts or omissions that may result under Section 58.10(e)(1)-(7) of the Act (415 ILCS 5/58.10(e)(1)-(7)) in the avoidance of the Letter include, but shall not be limited to:
- a) Any violation of institutional controls or land use restrictions, if applicable;
 - b) The failure to operate and maintain preventive or engineering controls or to comply with any applicable groundwater monitoring plan;
 - c) The disturbance or removal of contamination that has been left in place in accordance with the Remedial Action Plan, if applicable;
 - d) The failure to comply with the recording requirements for the Letter;
 - e) Obtaining the Letter by fraud or misrepresentation;
 - f) Subsequent discovery of contaminants, not identified as part of the investigative or remedial activities upon which the issuance of the Letter was based, that pose a threat to human health or the environment;
 - g) The failure to pay the No Further Remediation Assessment Fee within 45 days after receiving a request for payment from the Illinois EPA;
 - h) The failure to pay in full the applicable fees under the Review and Evaluation Service Agreement within 45 days after receiving a request for payment from the Illinois EPA;
4. Where the Remediation Applicant is not the sole owner of the remediation site, the Remediation Applicant shall complete the attached "Property Owner Certification of NFR Letter Under the Site Remediation Program" form. This certification by original signature of each property owner, or the authorized agent of the owner(s), of the remediation site or any portion thereof who is not an Remediation Applicant shall be recorded along with this Letter.

Pursuant to Section 58.10(d) of the Act, the No Further Remediation Letter shall apply in favor of the following persons:

1. The Remediation Applicant or other person to whom the letter was issued;
2. The owner and operator of the remediation site;
3. Any parent corporation or subsidiary of the owner of the remediation site;
4. Any co-owner, either by joint-tenancy, right of survivorship, or any other party sharing a relationship with the owner of the remediation site;
5. Any holder of a beneficial interest of a land trust or inter vivos trust, whether revocable or irrevocable, involving the remediation site;
6. Any mortgage or trustee of a deed of trust of the owner of the remediation site or any assignee, transferee, or any successor-in-interest of the owner of the remediation site;
7. Any successor-in-interest of the owner of the remediation site;
8. Any transferee of the owner of the remediation site whether the transfer was by sale, bankruptcy proceeding, partition, dissolution of marriage, settlement or adjudication of any civil action, charitable gift, or bequest;
9. Any heir or devisee of the owner of the remediation site;
10. Any financial institution, as that term is defined in Section 2 of the Illinois Banking Act and to include the Illinois Housing Development Authority, that has acquired the ownership, operation, management, or control of the remediation site through foreclosure or under the terms of a security interest held by the financial institution, under the terms of an extension of credit made by the financial institution, or any successor in interest thereto; or
11. In the case of a fiduciary (other than a land trustee), the estate, trust estate, or other interest in property held in a fiduciary capacity, and a trustee, executor, administrator, guardian, receiver, conservator, or other person who holds the remediated site in a fiduciary capacity, or a transferee of such party.

This Letter, including all attachments, must be filed as a single instrument with the Office of the Recorder or Registrar of Titles of Cook County within 45 days of its receipt. For recording purposes, it is recommended that the SRP Environmental Notice attached to this Letter be the first page of the instrument filed. This Letter shall not be effective until officially recorded by the Office of the Recorder or Registrar of Titles of Cook County in accordance with Illinois law so that it forms a permanent part of the chain of title for the U.S. Steel South Works property . Within 30 days of

this Letter being recorded by the Office of the Recorder or Registrar of Titles of Cook County, a certified copy of this Letter, as recorded, shall be obtained and submitted to the Illinois EPA.

Mr. Robert O'Hara
Illinois Environmental Protection Agency
Bureau of Land/RPMS Section
1001 North. Grand Ave. East.
Springfield, IL 62702

A No Further Remediation Fee, in the amount of the lesser of \$2,500 or an amount equal to the cost incurred for the remediation site by the Illinois EPA for review and evaluation services shall be delivered or mailed to the Illinois EPA at the following address:

Illinois Environmental Protection Agency
Division of Administration
Fiscal Services Section #2
2200 Churchill Road
P.O. Box 19276
Springfield, IL 62794-9276

The No Further Remediation Assessment Fee shall be made payable by check or money order to "**Treasurer-State of Illinois for Deposit in the Hazardous Waste Fund**". The check or money order shall identify the Illinois Inventory I.D. Number for the remediation site and the federal employer identification number or social security number of the RA. Request for final payment for the No Further Remediation Assessment Fee will be included with the final billing statement.

If you have any questions regarding this correspondence, you may contact the Illinois EPA project manager, Vickie Moy at (708) 338-7891.

Sincerely,

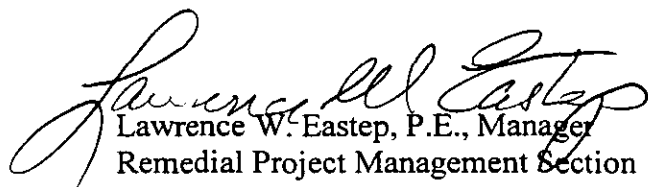
Lawrence W. Eastep, P.E., Manager
Remedial Project Management Section
Division of Remediation Management

cc: Andy Kubala - Waste Technology Inc.

Attached: SRP Environmental Notice
Site Base Map

PREPARED BY:

Name: J. David Moniot
U.S. Steel

Address: 600 Grant Street
Pittsburgh, PA 15219-2749

RETURN TO:

Name: J. David Moniot
U.S. Steel

Address: 600 Grant Street
Pittsburgh, PA 15219-2749

**THE ABOVE SPACE FOR
RECORDER'S OFFICE**

This Environmental No Further Remediation letter must be submitted by the Remedial Applicant within 45 days of its receipt, to the Recorder of Deeds of Cook County in which the remediation site (as described below) is located.

Illinois State EPA Number: 0316515061 (10-digit Illinois Inventory Number)

U.S. Steel, the Remediation Applicant, whose address is 600 Grant Street, Pittsburgh, PA, has performed investigative and/or remedial activities for the remediation site depicted on the attached Site Base Map and which remediation site can be identified by the following:

1. Legal description or Reference to a Plat Showing the Boundaries:

MAIN PLANT
PARCEL NO. 1

A parcel of land in Section Thirty-two (32), Township Thirty-eight (38) North, Range Fifteen (15) East, and in Section Five (5), Township Thirty-seven (37) North, Range Fifteen (15) East of the Third Principal Meridian in the City of Chicago, Cook County, Illinois, and being more particularly described as follows:

Beginning at the Southeast corner of Brandon Avenue and 79th Street, said POINT OF BEGINNING being 33 feet south of and 33 feet east of the Northwest corner of said Section Thirty-two (32); thence North Eighty-eight degrees, Fifty-seven minutes, Twenty-five seconds East (N88°57'25"E) along a line parallel to and 33 feet south of the North line of said Section Thirty-two (32)(basis of bearings), a

(Illinois EPA Site Remediation Program Environmental Notice)

distance of One thousand six hundred seventy-seven and zero hundredths feet (1,677.00'); thence South Sixty-one degrees, Twenty-nine minutes, Thirty-six seconds East (S61°29'36"E) along the dockwall and dockwall extended, a distance of Three thousand ten and zero hundredths feet (3,010.00') to an angle point in said dockwall; thence South Five degrees, Forth-four minutes, Twelve seconds east (S5°44'12"E) along said dockwall, a distance of Five thousand two hundred twenty-one and twenty-seven hundredths feet (5,221.27') to the North line of the Calumet River Pier; thence South Sixty degrees, Twenty-one minutes, Twenty-eight seconds West (S60°21'28"W) along the North line of said Calumet River Pier, a distance of Two thousand four hundred ninety-three and twenty-two hundredths feet (2,493.22') to the East line of the USS South Works South Slip; thence South Fifty-six degrees, Forty-eight minutes, Five seconds West (S56°48'05"W) across said Slip, a distance of Three hundred thirty-four and nineteen hundredths feet (334.19') to the North line of the Calumet River at the West line of said Slip; thence South Sixty degrees, Nineteen minutes, Fifteen seconds West (S60°19'15"W) along the North line of the Calumet River, a distance of Five hundred seventeen and fifty-four hundredths feet (517.54') to the Easterly corner of a parcel deeded to the Elgin, Joliet, and Eastern Railway Company in September, 1972; thence North Twenty-nine degrees, Forty minutes, Thirty-one seconds West (N29°40'31"W) along the Easterly line of said E, J, & E Ry. parcel, a distance of Twenty-five and zero hundredths feet (25.00') to the Northerly corner of said E, J, & E Ry. parcel; thence South Sixty-six degrees, Thirty-three minutes, Two seconds West (S66°33'02"W) along the Northerly line of said E, J, & E Ry. parcel, a distance of Fifty-five and thirty-three hundredths feet (55.33') to the Westerly corner of said E, J, & E Ry. parcel; thence North Twenty-nine degrees, Thirteen minutes, Nineteen seconds West (N29°13'19"W), a distance of Two hundred fifty-seven and forty-four hundredths feet (257.44') to a point that is Forty-six feet (46') Southeasterly of, measured at right angles to, the Southerly line of Harbor Avenue; thence North Sixty degrees, Nineteen minutes, Fifty-six seconds East (N60°19'56"E) along a line parallel to and Forty-six feet (46') southeasterly of the southerly line of Harbor Avenue, a distance of One hundred five and four hundredths feet (105.04') to the East line of Avenue "O" extended; thence North One degree, Five minutes, Nineteen seconds West (N1°05'19"W) along the East line of Avenue "O", a distance of One thousand Four Hundred Sixty-Six and Sixty hundredths feet (1,466.60') to the North line of 89th Street; thence South Eighty-nine degrees, One minutes, Thirteen seconds West (S89°01'13"W) along the North line of 89th Street, a distance of Seven hundred sixty-one and thirty-six hundredths feet (761.36') to the East line of Mackinaw Avenue; thence North One degree, Four minutes, Five seconds West (N1°04'05"W) along the East line of Mackinaw Avenue, a distance of One thousand three hundred thirty-one and eighty-four hundredths feet (1,331.84') to the north line of 87th Street; thence South Eighty-nine degrees, Two minutes, Thirty-four seconds West (S89°02'34"W) along the North line of 87th Street, a distance of Five hundred fifty-five and fifty-five hundredths feet (555.55') to the East line of Burley Avenue; thence North Forty-five degrees, Fifty-seven minutes, Nineteen seconds West (N45°57'19"W) along the Easterly line of Burley Avenue, Fifty-six and fifty-seven hundredths feet (56.57'); thence North Zero degrees, Fifty-seven minutes, Twelve seconds West (N0°57'12"W) along the East line of Burley Avenue, a distance of Five hundred forty-nine and eighty-seven hundredths feet (549.87') to the south line of 86th Street; thence North Eight-nine degrees, One minute, Twenty-three seconds East (N89°01'23"E) along the south line of 86th Street, a distance of Nine hundred seventy-four and seven hundredths feet (974.07') to the East line of Green Bay Avenue; thence North Zero degrees, Fifty-six minutes Forty-nine seconds West (N0°56'49"W) along the East line of Green Bay Avenue, a distance of Six hundred sixty-three and twenty-two hundredths feet (663.22'); thence South Eighty-nine degrees, Three minutes, Nine seconds

West (S89°03'09"W), a distance of Eight and zero hundredths feet (8.00'); thence North Zero degrees, Fifty-six minutes, Forth-nine seconds, West (N0°56'49"W) along the East line of Green Bay Avenue, a distance of One thousand three hundred ninety and eighty-eight hundredths feet (1,390.88') to the North line of 83rd Avenue; thence South Eight-nine degrees, Two minutes, seventeen seconds West (S89°02'17"W) along the North line of 83rd Avenue, a distance of Three hundred twenty-nine and eighty-eight hundredths feet (329.88') to the East line of Mackinaw Avenue; thence North One degree, One minutes, Twenty-one seconds West (N1°01'21"W) along the East line of Mackinaw Avenue, a distance of Two hundred ninety-six and ninety-three hundredths feet (296.93'); thence South Eighty-nine degrees, Four minutes, Eight seconds West (S89°04'08"W), a distance of Nine hundred Eight-nine and eighty-nine hundredths feet (989.89') to the East line of Brandon Avenue; thence North Zero degrees, Fifty-six minutes, Forty-eight seconds West (N0°56'48"W) along the East line of Brandon Avenue, a distance of Two thousand two hundred eighty-seven and fourteen hundredths feet (2,287.14') to the POINT OF BEGINNING;

EXCEPTING therefrom, the five herein described parcels occupied by the United States Government, the North Slip, the South Slip, and the Elgin, Joliet, and Eastern Railway Company:

PARCEL A: A parcel deeded to the Elgin, Joliet, and Eastern Railway Company (Document No. 22055116, dated September 19, 1972) described as follows: commencing at the intersection of the East line of Burley Avenue and the centerline of 86th Street; thence South Zero degrees, Fifty-seven minutes, Twelve seconds East (S0°57'12"E), a distance of Thirty-one and twenty-three hundredths feet (31.23') to the POINT OF BEGINNING of this exception; thence North Eighty-eight degrees, Fifty-two minutes, Fifty-two seconds East (N88°52'52"E), a distance of Six hundred two and forty hundredths feet (602.40'); thence South Zero degrees, Thirteen minutes, Twenty-four seconds West (S0°13'24"W), a distance of Four hundred twelve and seventy-one hundredths feet (412.71"); thence North Sixty-eight degrees, Twenty-four minutes, Eight seconds West (N68°24'08"W), a distance of Two hundred sixteen and sixty-one hundredths feet (216.61'); thence North One degree, One minutes, Forty seconds West (N1°01'40"W), a distance of Fifty-nine and seventy-four hundredths feet (59.74'); thence North Fifty-one degrees, Twenty-seven minutes, Thirty-nine seconds West (N51°27'39"W), a distance of One hundred ninety-five and twelve hundredths feet (195.12'); thence South Eighty-eight degrees, Forty minutes, Twenty-two seconds West (S88°40'22"W), a distance of Eighty-seven and twelve hundredths feet (87.12'); thence South One degree, Nineteen minutes, Thirty-eight seconds East (S1°19'38"E), a distance of One hundred sixty-five and eighty hundredths feet (165.80'); thence South Eighty-eight degrees, Forty minutes, Twenty-three seconds West (S88°40'23"W), a distance of Eighty-eight and seventy-eight hundredths feet (88.78'); thence North One degree, Nineteen minutes, Thirty-eight seconds West (N1°19'38"W), a distance of Forty-five and thirty-five hundredths feet (45.35'); thence South Eighty-nine degrees, Thirty-one minutes, Fifty-two seconds West (S89°31'52"W), a distance of Sixty-eight and twelve hundredths feet (68.12'); thence North Zero degrees, Fifty-seven minutes, Eight seconds West (N0°57'08"W), a distance of Two hundred sixty-five and zero hundredths feet (265.00') to the POINT OF BEGINNING; and containing Three and seven hundred ninety-four thousandths acres (3.794 ac. ±), more or less;

PARCEL B (North Slip): A parcel beginning on the East Dockwall at the North line of the North Slip, at a point Three thousand eight hundred eighty-seven and thirty-three hundredths feet (3,887.33') South

of and Four thousand six hundred and seventy-four hundredths feet (4,600.74') East of the Northwest corner of Section Thirty-two (32), Township Thirty-eight (38) North, Range Fifteen (15) East of the Third Principal Meridian; thence South Eighty-nine degrees, Fifty-nine minutes, Seven seconds West (S89°59'07"W) along the North line of the North Slip, a distance of One hundred ninety-three and forty-nine hundredths feet (193.49'); thence continuing along said North line South Zero degrees, Fifty-five minutes, Five Seconds East (S00°55'05"E), a distance of Sixty-eight and zero hundredths feet (68.00'); thence continuing along said North line South Eight-nine degrees, Four minutes, Fifty-five seconds West (S89°04'55"W), a distance of Two thousand five hundred three and thirty-three hundredths feet (2,503.33') to the West line of said North Slip; thence South Zero degrees, Fifty-five minutes, Five seconds East (S00°55'05"E) along said West line, a distance of One hundred ninety-five and ninety-seven hundredths feet (195.97') to the South line of said North Slip; thence North Eighty-nine degrees, Four minutes, Fifty-five seconds East (N89°04'55"E) along said South line, a distance of Two thousand seven hundred nineteen and ten hundredths feet (2,719.10') to the Dockwall; thence North Five degrees, Forty-four minutes, Twelve seconds West (N5°44'12"W) across the mouth of said North Slip, a distance of Two hundred sixty-five and twenty-three hundredths feet (265.23') to POINT OF BEGINNING, and containing Twelve and five hundred three thousandths acres (12.503 ac. ±), more or less;

PARCEL C (South Slip): A parcel beginning on the North line of the Calumet River at the Easterly line of the South Slip at a point Two thousand five hundred seventy-two and seventy-seven hundredths feet (2,572.77') South of and Two thousand six hundred twenty-three and twenty-four hundredths feet (2,623.24') East of the Northwest corner of Section Five (5), Township Thirty-seven (37) North, Range Fifteen (15) East of the Third Principal Meridian; thence North Fifty-nine degrees, Twenty-six minutes, Twenty-six seconds West (N59°26'26"W) along the East line of said South Slip, a distance of Fifty and fifty-six hundredths feet (50.56'); thence North Nineteen degrees, Twenty-three minutes, Thirty seconds West (N19°23'30"W) along the East line of said South Slip, a distance of One thousand two hundred twenty-two and eighty hundredths feet (1,222.80') to the North line of said South Slip; thence South Seventy degrees, Thirty-six minutes, Thirty seconds West (S70°36'30"W) along said North line, a distance of Sixty and zero hundredths feet (60.00') to the West line of said South Slip; thence South One degree, Five minutes, Twenty-three seconds East (S1°05'23"E) along said West line, a distance of three hundred twenty-four and eighty-two hundredths feet (324.82'); thence South Nineteen degrees, Twenty-three minutes, Thirty seconds East (S19°23'30"E) along said West line, a distance of Five hundred seventy-one and sixty-two hundredths feet (571.62'); thence South Twenty-five degrees, Thirty-six minutes, Thirty seconds West (S25°36'30"W) along said West line, a distance of One hundred eighty-three and eighty-five hundredths feet (183.85'); thence South Nineteen degrees, Twenty-three minutes, Thirty seconds East (S19°23'30"E) along said West line, a distance of Three hundred thirty-one and twenty-five hundredths feet (331.25') to the North line of the Calumet River; thence North Fifty-six degrees, Forty-eight minutes, Five seconds East (N56°48'05"E) across the mouth of said South Slip, a distance of Three hundred thirty-four and nineteen hundredths feet (334.19') to the POINT OF BEGINNING, and containing Five and five hundred eighty-seven thousandths acres (5.587 ac. ±), more or less;

PARCEL D (U. S. Gov't. Parcel No. 1): A parcel of land beginning at the intersection of the East Dockwall and the North line of the Calumet River Pier, said point being One thousand three hundred

thirty-nine and sixty-six hundredths feet (1,339.66') South of and Four thousand seven hundred ninety and seventeen hundredths feet (4,790.17') East of the Northwest corner of Section Five (5), Township Thirty-seven (37) North, Range Fifteen (15) East of the Second Principal Meridian; thence south Sixty degrees, Nineteen minutes, Fifteen seconds West (S60°21'28"W) along the North line of said Calumet River Pier, a distance of Four hundred fifty and zero hundredths feet (450.00'); thence North Twenty-nine degrees, Thirty-eight minutes, Thirty-three seconds West (N29°38'33"W), a distance of One hundred fifty and zero hundredths feet (150.00'); thence North Sixty degrees, Twenty-one minutes, Twenty-six seconds East (N60°21'26"E), a distance of Five hundred sixteen and forty-nine hundredths feet (516.49') to the East Dockwall; thence South Five degrees, Forty-four minutes, Twelve seconds East (S5°44'12"E) along said East Dockwall, a distance of One hundred sixty-four and eight hundredths feet (164.08') to the POINT OF BEGINNING, and containing One and six hundred sixty-four thousandths acres (1.664 ac. ±), more or less;

PARCEL E (U. S. Gov't. Parcel No. 2): A parcel of land beginning at a point on the North line of the Calumet River, said point being Two thousand seven hundred seventy-one and zero hundredths feet (2,771.00') South of and Two thousand three hundred sixteen and eighty-four hundredths feet (2,316.84') East of the Northwest corner of Section Five (5), Township Thirty-seven (37) North, Range Fifteen (15) East of the Second Principal Meridian; thence North Twenty-nine degrees, Forty minutes, Forty-five seconds West (N29°40'45"W), a distance of Three hundred four and forty hundredths feet (304.40'); thence South Sixty degrees, Nineteen minutes, Fifteen seconds West (S60°19'15"W), a distance of One hundred and zero hundredths feet (100.00'); thence South Twenty-nine degrees, Forty minutes, Forty-five seconds East (S29°40'45"E), a distance of Three hundred four and forty hundredths feet (304.40') to the North line of said Calumet River; thence North Sixty degrees, Nineteen minutes, Fifteen seconds East (N60°19'15"E) along said North line, a distance of One hundred and zero hundredths feet (100.00') to the POINT OF BEGINNING, and containing Zero and six hundred ninety-nine thousandths acres (0.699 ac. ±), more or less; and containing Five hundred sixty-six and nine hundred eighteen thousandths net acres (566.918 ac. ±), more or less.

MAIN PLANT PARKING LOT
PARCEL NO. 2

A parcel of land in the southwest Quarter (SW 1/4) of Section Thirty-two (32), Township Thirty-eight (38) North, Range Fifteen (15) East of the Third Principal Meridian, in the City of Chicago, Cook County, Illinois, and being more particularly described as follows:
Commencing at the Southwest Corner of said Section Thirty-two (32); thence North Eighty-nine degrees, Two minutes, Thirty-four seconds East (N89°02'34"E) along the South line of said section Thirty-two (32), a distance of One hundred fifty-five and zero hundredths feet (155.00'); thence North Zero degrees, Fifty-seven minutes, Twelve seconds West (N00°57'12"W), a distance of Forty and zero hundredths feet (40.00') to the POINT OF BEGINNING, said point being on the North Right-of-Way line of 87th St.; thence North Eighty-nine degrees, Two minutes, Thirty-four seconds East (N89°02'34"E) along said North Right-of-Way line, a distance of One hundred twelve and zero hundredths feet (112.00') to the West line of Burley Ave.; thence North forty-four degrees, Two minutes, Forty-one seconds East (N44°02'41"E) along the West line of Burley Ave.; a distance of

(Illinois EPA Site Remediation Program Environmental Notice)

Twenty-eight and twenty-nine hundredths feet (28.29'); thence North Zero degrees, Fifty-seven minutes, Twelve seconds West (N00°57'12"W) along the West line of Burley Ave., a distance of five hundred Sixty-nine and ninety-nine hundredths feet (569.99') to the South line of 86th Street.; thence South Eighty-nine degrees, One minute, Twenty-three seconds West (S89°01'23"W) along the South line of 86th St., a distance of One hundred thirty-two and zero hundredths feet (132.00') to the Southerly line of the Elgin, Joliet, and Eastern Railway Co.; thence Northwesterly, a distance of Forty-eight and zero hundredths feet (48.00') along said Southerly line being the arc of a curve to the right, said curve having a radius of Eight hundred feet (800'), the long chord of which bears North Sixty-nine degrees, Twenty-nine minutes, Thirty-eight and nine tenths seconds West (N69°29'38.9"W), Forty-seven and ninety-nine hundredths feet (47.99'); thence South Thirty degrees, Fifty-three minutes, Twenty-eight and seven tenths seconds East (S30°53'28.7"E), a distance of Eighty-nine and fifty hundredths feet (89.50'); thence South Zero degrees, Fifty-seven minutes, Twelve seconds East (S00°57'12"E), a distance of Five hundred twenty-nine and ninety-two hundredths feet (529.92') to the POINT OF BEGINNING, and containing One and eight hundred fourteen thousandths acres (1.814 ac. ±), more or less.

2. Common Address: 3426 East 89th Street, Chicago, Illinois
3. Real Estate Tax Index/Parcel Index Number:
 - 21-32-100-002
 - 21-32-212-002
 - 21-32-213-002
 - 21-32-213-003
 - 21-32-213-004
 - 26-05-200-002
 - 26-05-200-004
4. Remediation Site Owner: U.S. Steel
5. Land Use: Residential or Industrial/Commercial
6. Site Investigation: Comprehensive

See NFR letter for other terms.

PARCEL No. 1**MAIN PARCEL****(USS-SWKS, USR-REALTY, E.J.&E. RY
AND U.S. GOV'T PARCELS 1 & 2)**

COURSE	BEARING	DISTANCE
1-2	N 88-57-25 E	1677.000'
2-3	S 61-29-36 E	3010.000'
3-10	S 5-44-12 E	5221.271'
10-13	S 60-21-28 W	2493.220'
13-20	S 56-48-05 W	334.193'
20-25	S 60-19-15 W	517.541'
25-26	N 29-40-31 W	25.000'
26-27	S 66-33-02 W	55.330'
27-29	N 29-13-19 W	257.435'
29-30	N 60-19-56 E	105.040'
30-31	N 1-05-19 W	1466.600'
31-33	S 89-01-13 W	761.360'
33-35	N 1-04-05 W	1331.838'
35-36	S 89-02-34 W	555.549'
36-37	N 45-57-19 W	56.567'
37-38	N 0-57-12 W	549.869'
38-40	N 89-01-23 E	974.064'
40-41	N 0-56-49 W	663.220'
41-42	S 89-03-09 W	8.000'
42-43	N 0-56-49 W	1390.880'
43-44	S 89-02-17 W	329.880'
44-45	N 1-01-21 W	296.930'
45-46	S 89-04-08 W	989.890'
46-1	N 0-56-48 W	2287.140'

EXCLUSIONS TO MAIN PARCEL**E.J.&E. RY**

COURSE	BEARING	DISTANCE
100-101	N 88-52-52 E	602.400'
101-102	S 0-13-24 W	412.709'
102-103	N 68-24-08 W	216.609'
103-104	N 1-01-40 W	59.736'
104-105	N 51-27-39 W	195.120'
105-106	S 88-40-22 W	87.120'
106-107	S 1-19-38 E	165.800'
107-108	S 88-40-23 W	88.780'
108-109	N 1-19-38 W	45.350'
109-110	S 89-31-52 W	88.120'
110-100	N 0-57-08 W	285.000'

EXCLUSIONS TO MAIN PARCEL (CONTINUED)

NORTH SLIP		
COURSE	BEARING	DISTANCE
220-221	S 89-59-07 W	193.493'
221-222	S 00-55-05 E	88.000'
222-5	S 89-04-55 W	2503.328'
5-6	S 00-55-05 E	195.970'
6-7	N 89-04-55 E	2719.100'
7-220	N 05-44-12 W	265.230'

SOUTH SLIP		
COURSE	BEARING	DISTANCE
13-14	N 59-26-26 W	50.561'
14-15	N 19-23-30 W	1222.800'
15-16	S 70-36-30 W	60.000'
16-17	S 01-05-23 E	324.820'
17-18	S 19-23-30 E	571.620'
18-19	S 25-36-30 W	183.850'
19-20	S 19-23-30 E	331.250'
20-13	N 56-48-05 E	334.193'

U.S. GOV'T PARCEL No. 1		
COURSE	BEARING	DISTANCE
9-10	S 5-44-12 E	164.080'
10-12	S 60-21-28 W	450.000'
12-11	N 29-38-33 W	150.000'
11-9	N 60-21-26 E	516.491'

U.S. GOV'T PARCEL No. 2		
COURSE	BEARING	DISTANCE
21-22	N 29-40-45 W	304.400'
22-23	S 60-19-15 W	100.000'
23-24	S 29-40-45 E	304.400'
24-21	N 60-19-15-E	100.000'

PARCEL No. 2

COURSE	BEARING	DISTANCE
A-B	N 89-02-34 E	112.00'
B-C	N 44-02-41 E	28.29'
C-D	N 00-57-12 W	569.99'
D-E	S 89-01-23 W	132.00'
E-F (LC)	N 69-29-38.9 W	47.99'
F-G	S 30-53-28.7 E	89.50'
G-A	S 00-57-12 E	529.95'

Site Base Map from Remedial Action Completion Report
U.S. Steel South Works (0316515061)

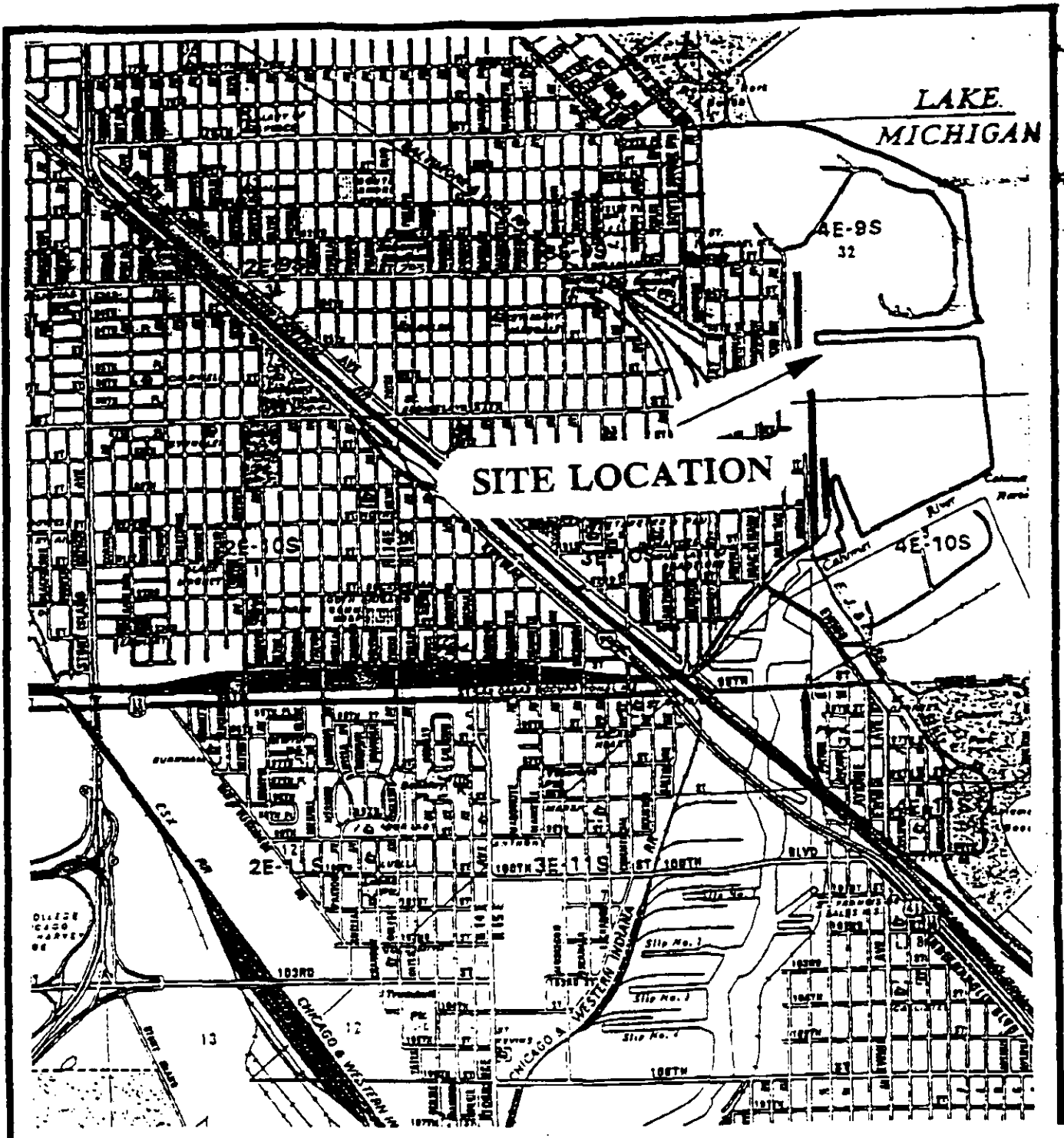

Site Base Map from Remedial Action Completion Report
 U.S. Steel South Works (0316515061)

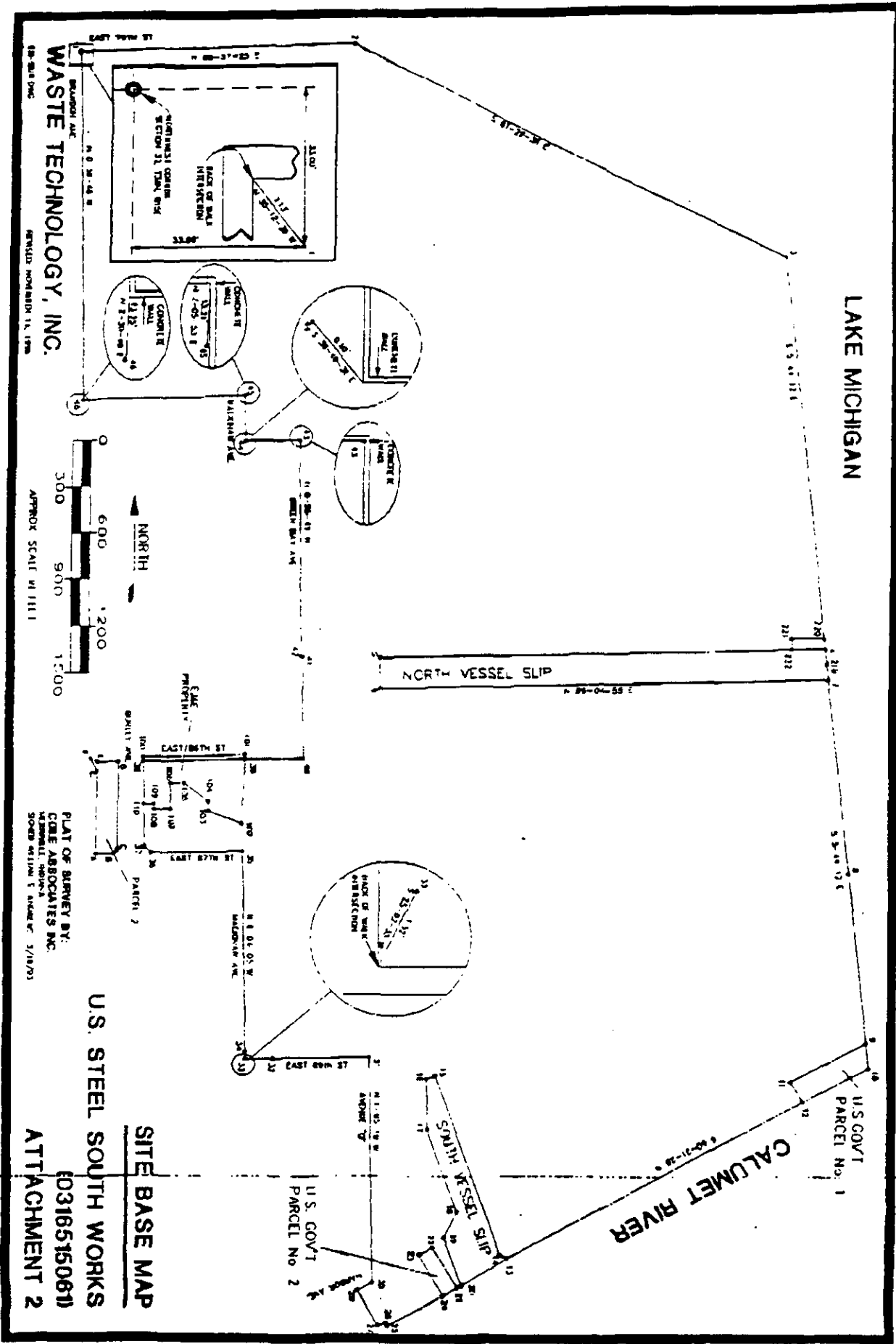

WASTE TECHNOLOGY, INC.
 10000 W. 111th St.
 Overland Park, KS 66211

PLAT OF SURVEY BY:
 COLE ASSOCIATES INC.
 10000 W. 111th St.
 Overland Park, KS 66211

U.S. STEEL SOUTH WORKS
 (0316515061)
 SITE BASE MAP
 ATTACHMENT 2

**PROPERTY OWNER CERTIFICATION OF NFR LETTER
UNDER THE SITE REMEDIATION PROGRAM**

If the Remediation Applicant is not the sole owner of the remediation site, include the full legal name, title, the company, the street address, the city, the state, the ZIP code, and the telephone number of all other property owners. Include the site name, street address, city, ZIP code, county, Illinois Inventory I.D. number and real estate tax index/parcel index number. The property owner(s), or the duly authorized agent of the owner(s) must certify, by original signature, the statement appearing below.

A duly authorized agent means a person who is authorized by written consent or by law to act on behalf of a property owner including, but not limited to:

1. For corporations, a principal executive officer of at least the level of vice-president;
2. For a sole proprietorship or partnership, the proprietor or a general partner, respectively; and
3. For a municipality, state or other public agency, the head of the agency or ranking elected official.

For multiple property owners, attach additional sheets containing the information described above, along with a signed, dated certification for each. All property owner certifications must be recorded along with the attached NFR letter.

Property Owner Information	
Owner's Name:	_____
Title:	_____
Company:	_____
Street Address:	_____
City:	State: _____ Zip Code: _____ Phone: _____
Site Information	
Site Name:	_____
Site Address:	_____
City:	State: _____ Zip Code: _____ County: _____
Illinois Inventory ID Number:	_____
Real Estate Tax Index/Parcel Index No.	_____
I hereby certify that I have reviewed the attached No Further Remediation Letter, and that I accept the terms and conditions and any land use limitations set forth in the letter.	
Owner's Signature:	Date: _____
SUBSCRIBED AND SWORN TO BEFORE ME this _____ day of _____, 19__	
_____ Notary Public	

The Illinois EPA is authorized to require this information under Sections 415 ILCS 5/58 - 58.12 of the Environmental Protection Act and regulations promulgated thereunder. If the Remediation Applicant is not also the sole owner of the remediation site, this form must be completed by all owners of the remediation site and recorded with the NFR Letter. Failure to do so may void the NFR Letter. This form has been approved by the Forms Management Center. All information submitted to the Site Remediation Program is available to the public except when specifically designated by the Remediation Applicant to be treated confidentially as a trade secret or secret process in accordance with the Illinois Compiled Statutes, Section 7(a) of the Environmental Protection Act, applicable Rules and Regulations of the Illinois Pollution Control Board and applicable Illinois EPA rules and guidelines.