

NPDES Permit No. IL0080068

Notice No. GY:14061001.bah

Public Notice Beginning Date: **December 17, 2014**

Public Notice Ending Date: **January 16, 2014**

National Pollutant Discharge Elimination System (NPDES)
Permit Program

PUBLIC NOTICE/FACT SHEET
of
Draft New NPDES Permit to Discharge into Waters of the State

Public Notice/Fact Sheet Issued By:

Illinois EPA
Division of Water Pollution Control
Permit Section
1021 North Grand Avenue East
Post Office Box 19276
Springfield, Illinois 62794-9276
217/782-0610

Name and Address of Discharger:

City of Morrison
200 West Main Street
Morrison, Illinois 61270

Name and Address of Facility:

City of Morrison WWTP
801 Portland Avenue
Morrison, Illinois 61270
(Whiteside County)

The Illinois Environmental Protection Agency (IEPA) has made a tentative determination to issue a NPDES Permit to discharge into the waters of the state and has prepared a draft Permit and associated fact sheet for the above named discharger. The Public Notice period will begin and end on the dates indicated in the heading of this Public Notice/Fact Sheet. All comments on the draft Permit and requests for hearing must be received by the IEPA by U.S. Mail, carrier mail or hand delivered by the Public Notice Ending Date. Interested persons are invited to submit written comments on the draft Permit to the IEPA at the above address. Commentors shall provide his or her name and address and the nature of the issues proposed to be raised and the evidence proposed to be presented with regards to those issues. Commentors may include a request for public hearing. Persons submitting comments and/or requests for public hearing shall also send a copy of such comments or requests to the Permit applicant. The NPDES Permit and notice numbers must appear on each comment page.

The application, engineer's review notes including load limit calculations, Public Notice/Fact Sheet, draft Permit, comments received, and other documents are available for inspection and may be copied at the IEPA between 9:30 a.m. and 3:30 p.m. Monday through Friday when scheduled by the interested person.

If written comments or requests indicate a significant degree of public interest in the draft Permit, the permitting authority may, at its discretion, hold a public hearing. Public notice will be given 45 days before any public hearing. Response to comments will be provided when the final Permit is issued. For further information, please call Getie Yilma at 217/782-0610.

The following water quality and effluent standards and limitations were applied to the discharge:

Title 35: Environmental Protection, Subtitle C: Water Pollution, Chapter I: Pollution Control Board and the Clean Water Act were applied in determining the applicable standards, limitations and conditions contained in the draft Permit.

The applicant is engaged in treating domestic wastewater for the City of Morrison.

The length of the Permit is approximately 5 years.

The main discharge number is 008. The seven day once in ten year low flow (7Q10) of the receiving stream, Rock Creek is 16.1 cfs.

The design average flow (DAF) for the facility is 0.941 million gallons per day (MGD) and the design maximum flow (DMF) for the facility is 2.586 MGD. Treatment consists of screening, grit removal, activated sludge, UV disinfection, and aerobic sludge digestion.

This new facility, which will replace the existing treatment plant (IL0027006), will have the same design average flow as the existing treatment plant. The effluent outfall for the new facility will be located about 0.75 miles downstream of the existing discharge on Rock Creek. Since there will be no increase in pollutant loading over the existing plant and Rock Creek at the new discharge location already receives the existing loading, no antidegradation assessment is needed.

Pursuant to the waiver provisions authorized by 40 CFR § 123.24, this draft permit is within the class, type, and size for which the Regional Administrator, Region V, has waived his right to review, object, or comment on this draft permit action.

Application is made for the New discharge(s) which is located in Whiteside County, Illinois. The following information identifies the discharge point, receiving stream and stream classifications:

Discharge Number	Receiving Stream	Latitude	Longitude	Stream Classification	Integrity Rating
008	Rock Creek	41° 47' 38" North	89° 58' 22" West	General Use	Not Rated

The stream segment(s) (Waterbody Segment PE-02) receiving the discharge from outfall(s) 008 is not on the 303 (d) list of impaired waters.

To assist you further in identifying the location of the discharge(s) please see the attached map.

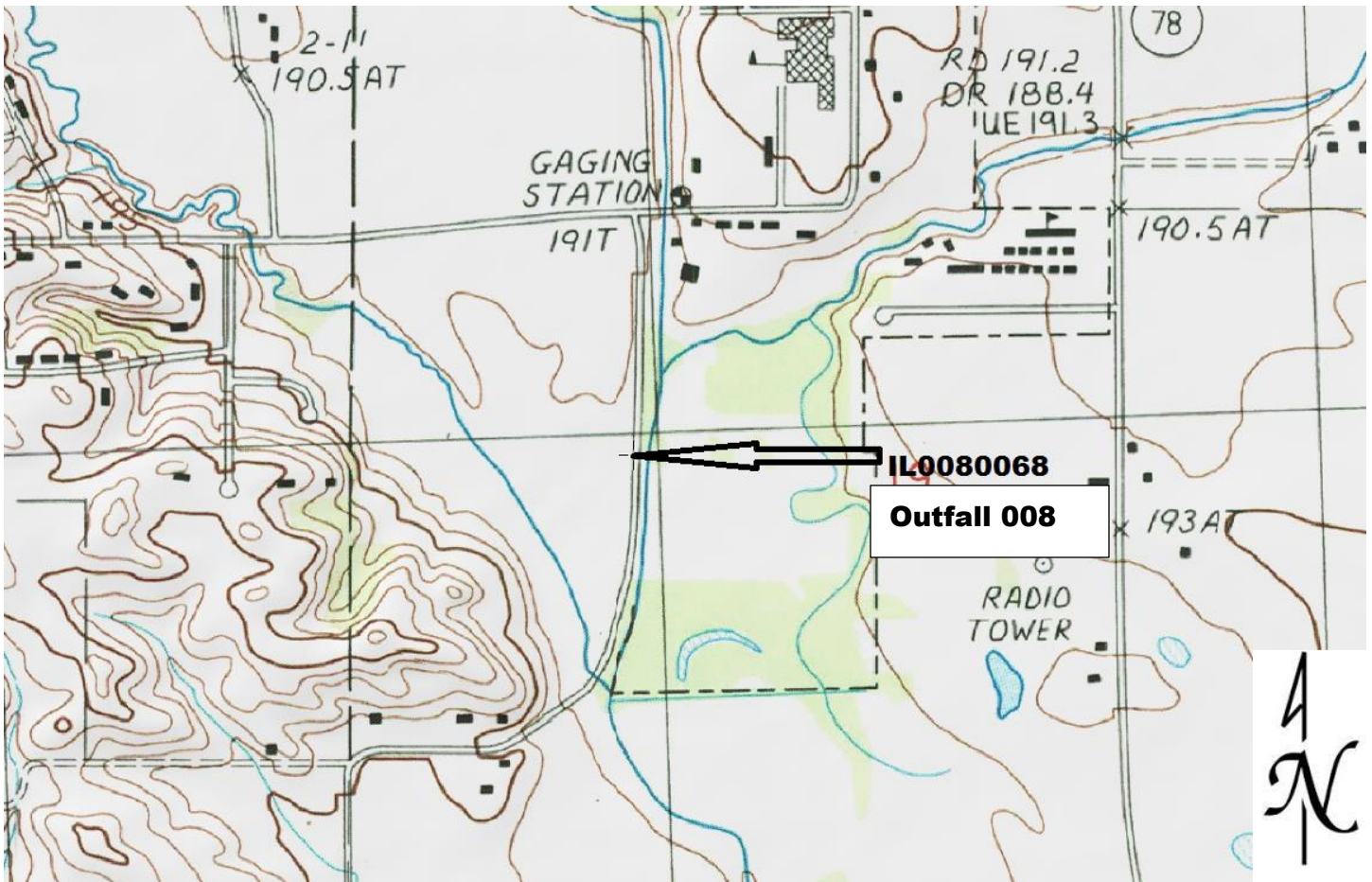

The discharge(s) from the facility is (are) proposed to be monitored and limited at all times as follows:

Discharge Number(s) and Name(s): 008 STP Outfall

Load limits computed based on a design average flow (DAF) of 0.941 MGD (design maximum flow (DMF) of 2.586 MGD).

The effluent of the above discharge(s) shall be monitored and limited at all times as follows:

Parameter	LOAD LIMITS lbs/day DAF (DMF)*			CONCENTRATION LIMITS mg/L			Regulation
	Monthly Average	Weekly Average	Daily Maximum	Monthly Average	Weekly Average	Daily Maximum	
CBOD ₅ **	196 (539)	314 (863)		25	40		35 IAC 304.120 40 CFR 133.102
Suspended Solids**	235 (647)	353 (971)		30	45		35 IAC 304.120 40 CFR 133.102
pH	Shall be in the range of 6 to 9 Standard Units						35 IAC 304.125
Fecal Coliform	Daily Maximum shall not exceed 400 per 100 mL (May through October)						35 IAC 304.121
Chlorine Residual						0.05	35 IAC 302.208
Ammonia Nitrogen: March -May/Sept.-Oct.	14 (39)		35 (95)	1.8		4.4	35 IAC 355 and 35 IAC 302
June-August	12 (32)	30 (82)	45 (123)	1.5	3.8	5.7	
Nov.-Feb.			28 (78)			3.6	

*Load Limits are calculated by using the formula: $8.34 \times (\text{Design Average and/or Maximum Flow in MGD}) \times (\text{Applicable Concentration in mg/L})$.

**BOD₅ and Suspended Solids (85% removal required): In accordance with 40 CFR 133, the 30-day average percent removal shall not be less than 85 percent except as provided in Sections 133.103 and 133.105

This draft Permit also contains the following requirements as special conditions:

1. Reopening of this Permit to include different final effluent limitations.
2. Operation of the facility by or under the supervision of a certified operator.
3. Submission of the operational data in a specified form and at a required frequency at any time during the effective term of this Permit.
4. More frequent monitoring requirement without Public Notice in the event of operational, maintenance or other problems resulting in possible effluent deterioration.
5. Prohibition against causing or contributing to violations of water quality standards.
6. Recording the monitoring results on Discharge Monitoring Report Forms using one such form for each outfall each month and submitting the forms to IEPA each month.
7. The provisions of 40 CFR Section 122.41(m) & (n) are incorporated herein by reference.
8. Effluent sampling point location.
9. A requirement to monitor and a limit of 0.05 mg/L for residual chlorine when it is used.
10. Seasonal fecal coliform limits.
11. Submission of annual fiscal data.
12. Prohibition against discharging from sanitary sewer overflows.
13. Submission of semi annual reports indicating the quantities of sludge generated and disposed.
14. Reopening of this Permit to include revised effluent limitations based on a Total Maximum Daily Load (TMDL) or other water quality study.
15. Capacity, Management, Operations and Maintenance (CMOM) requirements.
16. Notify IEPA upon completion of the proposed STP.

NPDES Permit No. IL0080068

Illinois Environmental Protection Agency

Division of Water Pollution Control

1021 North Grand Avenue East

Post Office Box 19276

Springfield, Illinois 62794-9276

NATIONAL POLLUTANT DISCHARGE ELIMINATION SYSTEM

New (NPDES) Permit

Expiration Date:

Issue Date:

Effective Date:

Name and Address of Permittee:

City of Morrison
200 West Main Street
Morrison, Illinois 61270

Facility Name and Address:

City of Morrison WWTP
801 Portland Avenue
Morrison, Illinois 61270
(Whiteside County)

Receiving Waters: Rock Creek

In compliance with the provisions of the Illinois Environmental Protection Act, Title 35 of the Ill. Adm. Code, Subtitle C, Chapter I, and the Clean Water Act (CWA), the above-named Permittee is hereby authorized to discharge at the above location to the above-named receiving stream in accordance with the standard conditions and attachments herein.

Permittee is not authorized to discharge after the above expiration date. In order to receive authorization to discharge beyond the expiration date, the Permittee shall submit the proper application as required by the Illinois Environmental Protection Agency (IEPA) not later than 180 days prior to the expiration date.

Alan Keller, P.E.
Manager, Permit Section
Division of Water Pollution Control

SAK:GY:14061001.bah

NPDES Permit No. IL0080068

Effluent Limitations, Monitoring, and Reporting

FINAL

Discharge Number(s) and Name(s): 008 STP Outfall

Load limits computed based on a design average flow (DAF) of 0.941 MGD (design maximum flow (DMF) of 2.586 MGD).

From the effective date of this Permit until the expiration date, the effluent of the above discharge(s) shall be monitored and limited at all times as follows:

Parameter	LOAD LIMITS lbs/day DAF (DMF)*			CONCENTRATION LIMITS mg/L			Sample Frequency	Sample Type
	Monthly Average	Weekly Average	Daily Maximum	Monthly Average	Weekly Average	Daily Maximum		
Flow (MGD)							Continuous	
CBOD ₅ ** ¹	196 (539)	314 (863)		25	40		2 Days/Week	Composite
Suspended Solids ¹	235 (647)	353 (971)		30	45		2 Days/Week	Composite
pH	Shall be in the range of 6 to 9 Standard Units						2 Days/ Week	Grab
Fecal Coliform***	Daily Maximum shall not exceed 400 per 100 mL (May through October)						2 Days/Week	Grab
Chlorine Residual						0.05	****	Grab
Ammonia Nitrogen: As (N)								
March-May/Sept.-Oct.	14 (39)		35 (95)	1.8		4.4	2 Days/Week	Composite
June-August	12 (32)	30 (82)	45 (123)	1.5	3.8	5.7	2 Days/Week	Composite
Nov.-Feb.			28 (78)			3.6	2 Days/Week	Composite

*Load limits based on design maximum flow shall apply only when flow exceeds design average flow.

**Carbonaceous BOD₅ (CBOD₅) testing shall be in accordance with 40 CFR 136.

***See Special Condition 10.

****See Special Condition 9.

¹ BOD₅ and Suspended Solids (85% removal required): In accordance with 40 CFR 133, the 30-day average percent removal shall not be less than 85 percent except as provided in Sections 133.103 and 133.105. The percent removal need not be reported to the IEPA on DMRs but influent and effluent data must be available, as required elsewhere in this Permit, for IEPA inspection and review. For measuring compliance with this requirement, 5 mg/L shall be added to the effluent CBOD₅ concentration to determine the effluent BOD₅ concentration.

Flow shall be reported on the Discharge Monitoring Report (DMR) as monthly average and daily maximum.

Fecal Coliform shall be reported on the DMR as a daily maximum value.

pH shall be reported on the DMR as minimum and maximum value.

Chlorine Residual shall be reported on DMR as daily maximum value.

NPDES Permit No. IL0080068

Influent Monitoring, and Reporting

The influent to the plant shall be monitored as follows:

<u>Parameter</u>	<u>Sample Frequency</u>	<u>Sample Type</u>
Flow (MGD)	Continuous	
BOD ₅	2 Days/Week	Composite
Suspended Solids	2 Days/Week	Composite

Influent samples shall be taken at a point representative of the influent.

Flow (MGD) shall be reported on the Discharge Monitoring Report (DMR) as monthly average and daily maximum.

BOD₅ and Suspended Solids shall be reported on the DMR as a monthly average concentration.

Special Conditions

SPECIAL CONDITION 1. This Permit may be modified to include different final effluent limitations or requirements which are consistent with applicable laws and regulations. The IEPA will public notice the permit modification.

SPECIAL CONDITION 2. The use or operation of this facility shall be by or under the supervision of a Certified Class 2 operator.

SPECIAL CONDITION 3. The IEPA may request in writing submittal of operational information in a specified form and at a required frequency at any time during the effective period of this Permit.

SPECIAL CONDITION 4. The IEPA may request more frequent monitoring by permit modification pursuant to 40 CFR § 122.63 and Without Public Notice.

SPECIAL CONDITION 5. The effluent, alone or in combination with other sources, shall not cause a violation of any applicable water quality standard outlined in 35 Ill. Adm. Code 302.

SPECIAL CONDITION 6. The Permittee shall record monitoring results on Discharge Monitoring Report (DMR) Forms using one such form for each outfall each month.

In the event that an outfall does not discharge during a monthly reporting period, the DMR Form shall be submitted with no discharge indicated.

The Permittee may choose to submit electronic DMRs (NetDMRs) instead of mailing paper DMRs to the IEPA. More information, including registration information for the NetDMR program, can be obtained on the IEPA website, <http://www.epa.state.il.us/water/net-dmr/index.html>.

The completed Discharge Monitoring Report forms shall be submitted to IEPA no later than the 25th day of the following month, unless otherwise specified by the permitting authority.

Permittees not using NetDMRs shall mail Discharge Monitoring Reports with an original signature to the IEPA at the following address:

Illinois Environmental Protection Agency
Division of Water Pollution Control
Attention: Compliance Assurance Section, Mail Code # 19
1021 North Grand Avenue East
Post Office Box 19276
Springfield, Illinois 62794-9276

SPECIAL CONDITION 7. The provisions of 40 CFR Section 122.41(m) & (n) are incorporated herein by reference.

SPECIAL CONDITION 8. Samples taken in compliance with the effluent monitoring requirements shall be taken at a point representative of the discharge, but prior to entry into the receiving stream.

SPECIAL CONDITION 9. For Discharge No. 008, any use of chlorine to control slime growths, odors or as an operational control, etc. shall not exceed the limit of 0.05 mg/L (daily maximum) total residual chlorine in the effluent. Sampling is required on a daily grab basis during the chlorination process. Reporting shall be submitted on the DMR's on a monthly basis.

SPECIAL CONDITION 10. Fecal Coliform limits for Discharge Number 008 are effective May thru October. Sampling of Fecal Coliform is only required during this time period.

SPECIAL CONDITION 11. During January of each year the Permittee shall submit annual fiscal data regarding sewerage system operations to the Illinois Environmental Protection Agency/Division of Water Pollution Control/Compliance Assurance Section. The Permittee may use any fiscal year period provided the period ends within twelve (12) months of the submission date.

Submission shall be on forms provided by IEPA titled "Fiscal Report Form For NPDES Permittees".

Special Conditions

SPECIAL CONDITION 12. Overflows from sanitary sewers are expressly prohibited by Ill. Adm. Code 306.304. Therefore, the Permittee is prohibited to discharge from the following sanitary sewer overflows (the use of an overflow point is subject to reporting requirements contained in Standard Condition 12(f) of this Permit):

<u>Discharge Number(s)</u>	<u>Name</u>
002	Lincolnway West
003	Willow and South Street
004	Waterworks Park Entrance
005	Winfield and Hall Street
006	Genesee Street
007	Wastewater Treatment Bypass

SPECIAL CONDITION 13. For the duration of this Permit, the Permittee shall determine the quantity of sludge produced by the treatment facility in dry tons or gallons with average percent total solids analysis. The Permittee shall maintain adequate records of the quantities of sludge produced and have said records available for IEPA inspection. The Permittee shall submit to the IEPA, at a minimum, a semi-annual summary report of the quantities of sludge generated and disposed of, in units of dry tons or gallons (average total percent solids) by different disposal methods including but not limited to application on farmland, application on reclamation land, landfilling, public distribution, dedicated land disposal, sod farms, storage lagoons or any other specified disposal method. Said reports shall be submitted to the IEPA by January 31 and July 31 of each year reporting the preceding January thru June and July thru December interval of sludge disposal operations.

Duty to Mitigate. The Permittee shall take all reasonable steps to minimize any sludge use or disposal in violation of this Permit.

Sludge monitoring must be conducted according to test procedures approved under 40 CFR 136 unless otherwise specified in 40 CFR 503, unless other test procedures have been specified in this Permit.

Planned Changes. The Permittee shall give notice to the IEPA on the semi-annual report of any changes in sludge use and disposal.

The Permittee shall retain records of all sludge monitoring, and reports required by the Sludge Permit as referenced in Standard Condition 23 for a period of at least five (5) years from the date of this Permit.

If the Permittee monitors any pollutant more frequently than required by the Sludge Permit, the results of this monitoring shall be included in the reporting of data submitted to the IEPA.

The Permittee shall comply with existing federal regulations governing sewage sludge use or disposal and shall comply with all existing applicable regulations in any jurisdiction in which the sewage sludge is actually used or disposed.

The Permittee shall comply with standards for sewage sludge use or disposal established under Section 405(d) of the CWA within the time provided in the regulations that establish the standards for sewage sludge use or disposal even if the permit has not been modified to incorporate the requirement.

The Permittee shall ensure that the applicable requirements in 40 CFR Part 503 are met when the sewage sludge is applied to the land, placed on a surface disposal site, or fired in a sewage sludge incinerator.

Monitoring reports for sludge shall be reported on the form titled "Sludge Management Reports" to the following address:

Illinois Environmental Protection Agency
Bureau of Water
Compliance Assurance Section
Mail Code #19
1021 North Grand Avenue East
Post Office Box 19276
Springfield, Illinois 62794-9276

SPECIAL CONDITION 14. This Permit may be modified to include alternative or additional final effluent limitations pursuant to an approved Total Maximum Daily Load (TMDL) Study or upon completion of an alternate Water Quality Study.

Special Conditions

SPECIAL CONDITION 15. The Permittee shall work towards the goals of achieving no discharges from sanitary sewer overflows or basement backups and ensuring that overflows or backups, when they do occur do not cause or contribute to violations of applicable standards or cause impairment in any adjacent receiving water. In order to accomplish these goals, the Permittee shall implement and submit to the IEPA a revised Capacity, Management, Operations, and Maintenance (CMOM) plan within twelve (12) months of the effective date of this Permit. The Permittee should work as appropriate, in consultation with affected authorities at the local, county, and/or state level to develop the plan components involving third party notification of overflow events. The Permittee may be required to construct additional sewage transport and/or treatment facilities in future permits or other enforceable documents should the implemented CMOM plan indicate that the Permittee's facilities are not capable of conveying and treating the flow for which they were designed.

The revised CMOM plan shall include the following elements:

a. Measures and Activities:

1. A complete map of the collection system owned and operated by the Permittee;
2. Schedules, checklists, and mechanisms to ensure that preventative maintenance is performed on equipment owned and operated by the Permittee;
3. An assessment of the capacity of the collection and treatment system owned and operated by the Permittee at critical junctions and immediately upstream of locations where overflows and backups occur or are likely to occur; and
4. Identification and prioritization of structural deficiencies in the system owned and operated by the Permittee.

b. Design and Performance Provisions:

1. Monitor the effectiveness of CMOM;
2. Upgrade the elements of the CMOM plan as necessary; and
3. Maintain summary of CMOM activities.

c. Overflow Response Plan:

1. Know where overflows within the facilities owned and operated by the Permittee occur;
2. Respond to each overflow to determine additional actions such as clean up; and
3. Locations where basement back-ups and/or sanitary sewer overflows occur shall be evaluated as soon as practicable for excessive inflow /infiltration, obstructions or other causes of overflows or back-ups as set forth in the System Evaluation Plan.

d. System Evaluation Plan.

e. Reporting and Monitoring Requirements.

f. Third Party Notice Plan:

1. Describes how, under various overflow scenarios, the public, as well as other entities, would be notified of overflows within the Permittee's system that may endanger public health, safety or welfare;
2. Identifies overflows within the Permittee's system that would be reported, giving consideration to various types of events including events with potential widespread impacts;
3. Identifies who shall receive the notification;
4. Identifies the specific information that would be reported including actions that will be taken to respond to the overflow;
5. Includes a description of the lines of communication; and
6. Includes the identities and contact information of responsible POTW officials and local, county, and/or state level officials.

SPECIAL CONDITION 16. The Permittee shall notify the IEPA in writing once the proposed treatment plant has been completed. A letter stating the date that the plant was completed shall be sent to the following address within fourteen (14) days of the plant becoming operational:

Illinois Environmental Protection Agency
Bureau of Water
Division of Water Pollution Control
Attention: Compliance Assurance Section
Mail Code #19
1021 North Grand Avenue East
Post Office Box 19276
Springfield, Illinois 62794-9276

